

TILLAMOOK COUNTY SURVEYORS OFFICE

1/4 corner common to sections 31 T.4S.,R.10W.,W.M
and section 36 T.4S.,R.11W.,W.M.

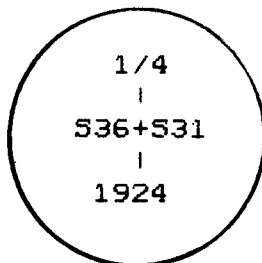

I found a 2 1/2" General Land Office Brass cap in concrete on a 1" O.D. iron pipe leaning in a mound of stone. I removed the brass cap and mass of concrete, which had been dislodged off of the iron pipe, straitened the iron pipe to a vertical position, and reset the brass cap in concrete over the top of the iron pipe and added more concrete to the monument.

History of found monument

I found this monument to be as described in Tillamook County Surveyors book 4S11 at page 20. This corner was rehabilitated by adding concrete in 1962 by The Bureau of Land Management in Tillamook County Rewitness book 3 at page 37.

Surveys of Reference

A-719	1957	John L. Carlich RS 287
B-513	1963	John A. Bond PE 2416
A-1174	1974	Bureau of Land Management
F-40-205	1974	Bureau of Land Management

New Accessory

*72" hat section post 1.75' South.

*indicates Tillamook County yellow metal location poster attached

Monument location

This corner is located on the Nestucca spit, (A.K.A. Bob Straub State Park), in a low sandy area.

In the presence of Dan McNutt & Al Dvorak

May 1990

Title

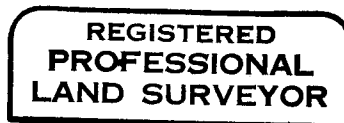

Allan E. Duncan, C.S.

